

# DH-IPC-HFE8841S-AS

8MP Explosion-proof IR Bullet WizMind Network Camera



ACUPICK

WizMind

Launched by Dahua Technology, Dahua WizMind is a full portfolio of solutions composed of project-oriented products including IPC, IVSS, NVR, PTZ, XVR, Thermal and software platform which adopts industry-leading deep learning algorithms. Focusing on customer's requirements, WizMind provides precise, reliable and comprehensive AI solutions for verticals.

## Series Overview

Equipped with starlight solution and large aperture lens, Dahua WizMind Explosion-Proof series network camera provides better image effects. With advanced deep learning algorithm, the camera supports various intelligent functions, such as perimeter protection, face detection and people counting, which improve the accuracy of video analysis. With certification of IECEx and ATEX, it is applicable to some specific energy industries such as coal, petroleum, and chemical industry.

## Functions

### Smart H.265+ & Smart H.264+

With advanced scene-adaptive rate control algorithm, Dahua smart encoding technology realizes the higher encoding efficiency than H.265 and H.264, provides high-quality video, and reduces the cost of storage and transmission.

### Face Detection

Dahua Face Detection technology can detect the face in the image. With deep learning algorithm, the technology supports detecting, tracking, capturing and selecting the best face image, and then outputs face snapshot.

### AcuPick

This industry-leading search technology effectively utilizes both front-end and back-end intelligence to help with searching through massive video data to quickly and conveniently locate targets with greater precision.

- 8-MP 1/2.8" CMOS image sensor, low luminance, and high definition image.
- Outputs max. 8 MP (3840 × 2160)@25/30 fps.
- Built-in IR LED, and the max. illumination distance is 50 m.
- With deep learning algorithm, it supports: Face Detection, IVS, People Counting and Heat Map, etc.
- Rotation mode, WDR, 3D NR, HLC, BLC, digital watermarking, applicable to various monitoring scenes.
- ROI, SMART H.264+/H.265+, AI H.264/H.265, flexible coding, applicable to various bandwidth and storage environments.
- Supports the AFSA(Anti-flicker Self-adaption) function, which automatically eliminates flicker.
- SMD 4.0 and AI SSA.
- Alarm: 1 in, 1 out; audio: 1 in, 1 out; supports max. 512 G Micro SD card.
- 12 VDC/PoE power supply, easy for installation.
- IP68 protection.
- Constructed from aluminum alloy with a high anti-corrosion coating, certified to NEMA 4X standards for corrosion resistance.
- ATEX and IECEx Certification.
- Explosion-proof mark: II 2 G Ex db IIC T6 Gb and II 2 D Ex tb IIIC T80°C Db.



## WDR

With advanced Wide Dynamic Range (WDR) technology, Dahua network camera provides clear details in the environment of strong brightness contrast. The bright and dark area can get clear video even in high brightness environment or with backlight shadow.

## Protection (IP68, Wide Voltage)

IP68: The camera passes a series of strict test on dust and soak. With the water-proof enclosure, the camera can work normally after soaking in 1.2 m deep water for 30 minutes.

Wide voltage: The camera allows ±30% (for some power supplies) input voltage tolerance (wide voltage range), and it is widely applied to outdoor environment with instable voltage.

## SMD 4.0

Dahua Smart Motion Detection technology works with intelligent algorithms to classify targets that trigger motion detection alarms. It filters out objects that are not targets, such as small and large animals, to avoid triggering false alarms. With an AI NVR, Quick Pick technology becomes available, allowing you to easily search for and pick out human and vehicle targets from SMD event videos, prioritizing the highest matches.

## Technical Specification

### Camera

Image Sensor	1/2.8" CMOS
Max. Resolution	3840 (H) × 2160 (V)
ROM	512 MB
RAM	2 GB
Scanning System	Progressive
Electronic Shutter Speed	Auto/Manual 1/3 s–1/100,000 s
Min. Illumination	0.007 lux@F1.6 (Color, 30 IRE) 0.0007 lux@F1.6 (B/W, 30 IRE) 0 lux (Illuminator on)
S/N Ratio	>56 dB
Illumination Distance	Up to 50 m (164.04 ft) (IR)
Illuminator On/Off Control	Auto;Manual
Illuminator Number	1 (IR LED)

### Lens

Lens Type	Fixed-focal
Lens Mount	M12
Focal Length	3.6 mm; 6 mm
Max. Aperture	F1.6
Field of View	3.6 mm: H: 84°; V: 47.8°; D: 96.5° 6 mm: H: 52.8°; V: 30.3°; D: 60.3°
Iris Control	Fixed
Close Focus Distance	3.6 mm: 2.0 m (6.56 ft) 6 mm: 3.6 m (11.81 ft)

	Lens	Detect	Observe	Recognize	Identify
DORI Distance	3.6 mm	102.1 m ( 334.97 ft)	40.8 m ( 133.86 ft)	20.4 m ( 66.93 ft)	10.2 m ( 33.46 ft)
	6 mm	160.0 m ( 524.93 ft)	48.0 m ( 157.48 ft)	24.0 m ( 78.74 ft)	12.0 m ( 39.37 ft)
	*DORI (Detect, Observe, Recognize, Identify) is a standard system (EN-62676-4) for defining the ability of a person viewing the video to distinguish persons or objects within a covered area. The numbers in this table do not reflect intelligent function distances. For intelligent function distances, refer to installation and commissioning manual/project design tool.				

### Smart Event

IVS	Abandoned object; missing object
-----	----------------------------------

### Intelligence

IVS (Perimeter Protection)	Intrusion, tripwire, fast moving (the three functions support the classification and accurate detection of vehicle and human); loitering detection, people gathering, and parking detection.
SMD	SMD 4.0
AcuPick	Uses deep learning algorithms and works with back-end devices to accurately match targets, such as people and motor vehicles, and search through live and recorded videos to quickly locate targets.

AI SSA	Adopt deep learning algorithms to adjust the parameters of the image to suit the conditions.
Face Detection	Face detection; track; snapshot; snapshot optimization; optimal face snapshot upload; face enhancement; face exposure; face attributes extraction including 6 attributes and 8 expressions; face snapshot set as face or one-inch photo; snapshot strategies (real-time snapshot, quality priority and optimization snapshot); face angle filter; optimization time setting.
People Counting	Tripwire people counting, generating and exporting report (day/week/month/year); people counting in area; queue management; 4 rules can be set for tripwire, people counting in area and queue management.
Heat Map	Yes
Smart Search	Work together with Smart NVR to perform refine intelligent search, event extraction and merging to event videos

### Video

Video Compression	H.265; H.264; H.264H; H.264B; MJPEG (Only supported by sub stream)
Smart Codec	Smart H.265+; Smart H.264+
AI Coding	AI H.265; AI H.264
Video Frame Rate	Main stream: 3840 × 2160@(1–25/30 fps) sub stream: 704 × 576@(1–25 fps)/704 × 480@(1–30 fps) third stream:1920 × 1080@(1–25/30 fps) *The values above are the max. frame rates of each stream; for multiple streams, the values will be subjected to the total encoding capacity.
Streaming Capability	3 streams
Resolution	8M (3840 × 2160); 6M (3200 × 1800); 5M (3072 × 1728); 4M (2688 × 1520/2560 × 1440); 3M (2304 × 1296); 1080p (1920 × 1080); 720p (1280 × 720); D1 (704 × 576/704 × 480); VGA (640 × 480); CIF (352 × 288/352 × 240 )
Bit Rate Control	VBR;CBR;ABR
Video Bit Rate	H.264: 3 kbps–16384 kbps; H.265: 3 kbps–16384 kbps
Day/Night	Auto(ICR)/Color/B/W
BLC	Yes
HLC	Yes
WDR	120 dB
Scene Self-adaptation (SSA)	Yes
White Balance	Auto; natural; street lamp; outdoor; manual; regional custom
Gain Control	Auto
Noise Reduction	3D NR
Motion Detection	OFF/ON (4 areas, rectangular)
Region of Interest (RoI)	Yes (4 areas)
Defog	Yes
Image Rotation	0°/90°/180°/270° (Support 90°/270° with 2688 × 1520 resolution and lower)

Mirror	Yes
Privacy Masking	4 areas

## Audio

Audio Compression	PCM; G.711a; G.711Mu; G.726; G.723
-------------------	------------------------------------

## Alarm

Alarm Event	No SD card; SD card full; SD card error; network disconnection; IP conflict; illegal access; motion detection; video tampering; tripwire; intrusion; fast moving; abandoned object; missing object; loitering detection; people gathering; parking detection; scene changing; audio detection; voltage alarm; external alarm; face detection; security exception; SMD; people counting in area; stay detection; people counting; people number error detection; queue people number alarm; queue time alarm
-------------	---

## Network

Network Port	RJ-45 (10/100 Base-T)
SDK and API	Yes
Network Protocol	IPv4; IPv6; HTTP; TCP; UDP; ARP; RTP; RTSP; RTCP; RTMP; SMTP; FTP; SFTP; DHCP; DNS; DDNS; QoS; UPnP; NTP; Multicast; ICMP; IGMP; NFS; SAMBA; PPPoE; SNMP; P2P
Interoperability	ONVIF (Profile S & Profile G & Profile T & Profile M); CGI
User/Host	20 (Total bandwidth: 80 M)
Storage	FTP; SFTP; Micro SD card (support max. 512 GB); NAS
Browser	IE: IE 11 and later; Chrome: Chrome 45 and later; Firefox: Firefox 46 and later; Safari: Safari 12 and later; Edge: Edge
Management Software	Smart PSS Lite; DSS; DMSS; DoLynk Care
Mobile Client	iOS; Android
Security	Digest; WSSE; Account logout; Security logs; IP/MAC filtering; Generation and importing of X.509 certification; syslog; HTTPS; 802.1x; Trusted boot; Trusted execution; Trusted upgrade; Session security; Security warning

## Certification

Certifications	CE-LVD: EN62368-1; CE-EMC: Electromagnetic Compatibility Directive 2014/30/EU; ATEX: TÜV 24 ATEX 9126 X; IECEX: IECEX TUR 24.0026X; UL 50E NEMA Type 4X
----------------	---

## Port

Audio Input	1 channel (terminal)
Audio Output	1 channel (terminal)
Alarm Input	1 channel in: wet contact, 5 mA 3–5 VDC
Alarm Output	1 channel out: wet contact, 300 mA 12 VDC

## Power

Power Supply	12 VDC (±30%); PoE (802.3af)
Power Consumption	Basic: 4.3 W (12 VDC); 4.9 W (PoE);

Power Consumption	Max.: 6.2 W (12 VDC); 8 W (PoE) (H.265+ intelligence on + WDR + IR on)
-------------------	--

## Environment

Operating Temperature	–40 °C to +60 °C (–40 °F to +140 °F)
Operating Humidity	≤95% (RH), non-condensing
Storage Temperature	–40 °C to +60 °C (–40 °F to +140 °F)
Storage Humidity	≤95% (RH), non-condensing
Protection	IP68
Anti-corrosion Level	Moderate Protection *The products feature high-grade anti-corrosion protection, making them well-suited for environments with standard corrosion resistance requirements. They perform reliably from 2 km (1.24 mi) and above in coastal areas and in locations prone to acid rain exposure.

## Structure

Casing Material	Metal
Product Dimensions	200.6 mm × 127 mm × 136 mm (7.90" × 5.00" × 5.35") (L × W × H)
Net Weight	2.1 kg (4.63 lb)
Gross Weight	2.5 kg (5.51 lb)

## Ordering Information

Type	Model	Description
EXPLOSION-PROOF CAMERA	DH-IPC-HFE8841S-AS	8MP Explosion-proof IR Bullet WizMind Network Camera
Accessories (Optional)	DH-PFB717WA-S1	Anti-corrosion Wall Mount Bracket
	ZAEX02	Explosion-proof Cable Gland
	ZANXG-1.0	Explosion-proof flexible conduit-M25-316L-1.0
	CZ300	Explosion-proof Control Box
	DH-PFM321-EN	DC12V1A power adapter
	DH-PFM320D-EN	DC12V2A power adapter
	PFM900-E	Integrated Mount Tester
	DHI-TF-P100/512GB	MicroSD Card

## Accessories

Optional:



CZ300  
Explosion-proof Control  
Box



DH-PFB717WA-S1  
Anti-corrosion Wall  
Mount Bracket



DH-PFM320D-EN  
DC12V2A power adapter



DH-PFM321-EN  
DC12V1A power adapter



DHI-TF-P100/512GB  
MicroSD Card



PFM900-E  
Integrated Mount Tester



ZAEX02  
Explosion-proof Cable  
Gland



ZANXG-1.0  
Explosion-proof flexible  
conduit-M25-316L-1.0

## Dimensions (mm[inch])

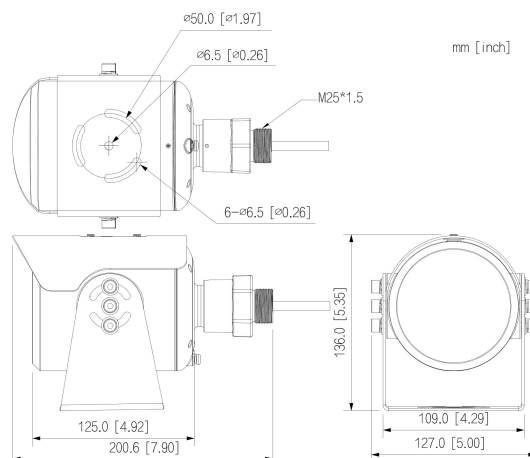

Wall Mount

