

DHI-WO1457GPT-S3

IP Face Recognition Apartment Door Station



Functions

Video Intercom

Video intercom can be used with the Indoor Monitor (VTH), Master Station (VTS) and app.

Scene

Ideal for use in multiple scenes such as office buildings, compound buildings, communities, etc.

Technical Specification

System

| | |
|------------------|--|
| Main Processor | Embedded Processor |
| Operating System | Embedded Linux OS |
| Button Type | Touch button |
| Interoperability | CGI;ONVIF |
| Network Protocol | TCP;RTMP;HTTP/HTTPS;DNS;RTSP;ONVIF;SIP;RTP |

Basic

| | |
|--------------------|---|
| Screen Type | Capacitive Touchscreen |
| Display Screen | 8-inch display screen |
| Screen Resolution | 800 (H) × 1280 (V) |
| Camera | 1/2.8" 2MP CMOS high-definition, low illumination, dual cameras |
| Field of View | H: 95°; V: 50°; D: 110° |
| WDR | 120 dB |
| Noise Reduction | 3D NR |
| Video Compression | H.264; H.265 |
| Video Resolution | Main stream: 720P/D1/WVGA; Sub stream: 1080P/720P/D1/WVGA/CIF/QVGA |
| Video Frame Rate | 25 fps |
| Video Bit Rate | 1,024 kbps–8,192 kbps |
| Light Compensation | Auto white light |

- 8" LCD with a resolution of 800 × 1280.
- 2MP HD camera/dual-lens camera.
- White light illuminators that help recognize the targets in darkness or low light environments.
- Supports 100,000 users, 50,000 faces, 50,000 cards, and 10,000 fingerprints.
- Recognizes faces 0.3 to 1.5 m away (0.98 ft–4.92 ft) at an accuracy of 99.9%, and compares 1 face with N faces at the speed of 0.2 seconds/person.
- Liveness detection is used to detect spoof attempt, such as using a photo or video to gain access.
- Receive and view text and image information released by the management center.
- Offers multiple types of alarms such as duress, tamper, emergency and alarms from door detectors.
- Supports leaving audio and video messages when no one responds through the indoor monitor. (an SD card is required)
- Supports multiple unlock methods including password, IC card, fingerprint, QR code(supported by DSS) and face, and unlocks remotely.
- Unlocks the door through the indoor monitor, management center and app.
- Provides 12 VDC, 500 mA power for the extension module or card reader
- IP65 rated (silicone sealant is required for the shell, see the quick start guide).
- Standard PoE power supply (If the VTO device with 12 V power output needs to charge the load, it should be connected to a PSE switch that complies with the 802.3.at standard).



| | |
|-------------------|--|
| Audio Compression | G.711a; G.711u; PCM |
| Audio Input | 1 channel |
| Audio Output | Built-in speaker |
| Audio Mode | Two-way audio |
| Audio Enhancement | Echo suppression/digital noise reduction |
| Audio Bit Rate | 16 kHz, 16 bit |

Function

| | |
|---------------------|---|
| Communication Mode | Full digital |
| Verification Method | Fingerprint;Remote;Face Recognition;Card;Password |

Apartment Door Station | DHI-VTO7531G-S3

| | |
|---------------------|--|
| Auto Snapshot | Yes |
| Information Release | Receive and view text information released by the management center. |
| Leave Videos | Yes (SD card is inserted in the indoor monitor or door station) |
| Storage | Supports Micro SD card (up to 512 GB) |
| Web Configuration | Yes |
| Auto Registration | Yes |

RFID

| | |
|-----------|---------|
| Card Type | IC card |
|-----------|---------|

Performance

| | |
|-------------------------------|-------------------------------|
| Card Reading Distance | 0 cm–4 cm (IC card) |
| Issue Card Locally | Yes |
| Face Recognition Height Range | 1.1 m–2.2 m (3.61 ft–7.22 ft) |
| Face Recognition Distance | 0.3 m–2.0 m (0.98 ft–6.56 ft) |
| Face Recognition Accuracy | 99.9% |
| Face Recognition Time | 0.2 sec |
| Fingerprint Sensor Type | Capacitive |
| Fingerprint Comparison Time | ≤1.5 sec |
| Fingerprint Recognition Time | ≤1 sec |
| Casing Material | Metal |

Capacity

| | |
|----------------------|--------|
| Card Capacity | 50,000 |
| Face Image Capacity | 50,000 |
| Fingerprint Capacity | 10,000 |

Port

| | |
|-----------------------|--|
| RS-485 | 1 |
| Wiegand | 1 (they can be set as an input or output port) |
| Alarm Input | 2 channels |
| Alarm Output | 2 channels |
| Power Output | 1 port (12 V, 500 mA) |
| Exit Button | 1 channel |
| Door Status Detection | 1 channel |
| Lock Control | 1 channel, open by default |
| Network Port | 1 × 10 Mbps/100 Mbps Ethernet port |

Alarm

| | |
|--------------|-----|
| Tamper Alarm | Yes |
|--------------|-----|

General

| | |
|----------------------|-----------------------------------|
| Unlock Password Mode | User, public and duress passwords |
|----------------------|-----------------------------------|

| | |
|-----------------------|--|
| Appearance Color | Silver |
| Power Supply | 12 VDC, 3 A; Standard PoE |
| Power Adapter | Optional |
| Installation | Flush Mount;Wall Mount |
| Certifications | CE |
| Accessory | Power supply (optional); Flush mount box (optional) |
| Product Dimensions | 389 mm × 145 mm × 43.5 mm (15.31" × 5.70" × 1.71") |
| Protection | IP65 rated (Silicone sealant is required. See the quick start guide for more information). |
| Operating Temperature | –30 °C to +60 °C (–22 °F to +140 °F) |
| Operating Humidity | 0%–90% (RH), non-condensing |
| Operating Altitude | 0 m–1,300 m (0 ft–4265.09 ft) |
| Power Consumption | ≤5 W (standby), ≤18 W (working) |
| Gross Weight | 1.91 kg (4.21 lb) |

Ordering Information

| Type | Model | Description |
|--------------|------------------|--|
| Door Station | DHI-WO1457GPT-S3 | IP Face Recognition Apartment Door Station |
| Accessories | VTM130 | Surface Mounted Box |
| | VTM121 | Flush Mounted Box |

Installation

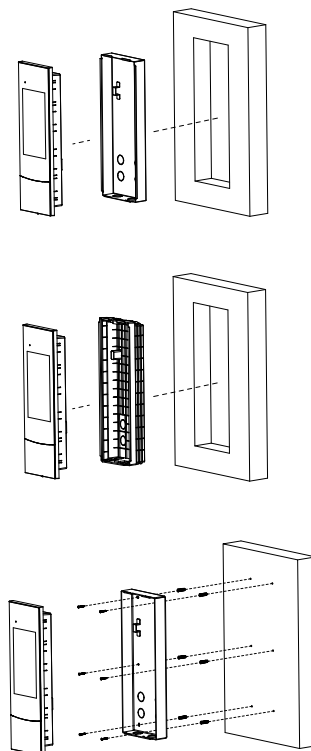

Dimensions (mm[inch])

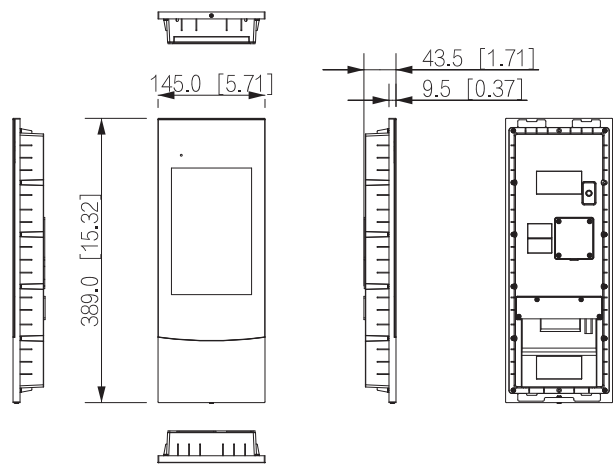

Application

